



# M205-LED

Marine Surface Mount Low Profile LED

## PRODUCT SPECIFICATION

# Overhead Lighting

## M205 Series

The M205 Series is designed for commercial marine and wet location surface mount ceiling applications. The design is drip-proof and easy to install and service.

### Mounting

Surface-mounts to ceilings.

### Light Source

LED.

### Lens

One-piece 5/32 in. prismatic polycarbonate lens.

### Housing

One-piece low profile aluminum housing with a liquid tight cord grip.

### Finish

Polyester powder-coated after phosphate pretreatment for superior adhesion and corrosion resistance.

### Weight

4 ft. luminaire: 6.8 lb. (3.1 kg)

2 ft. luminaire: 4.1 lb. (1.9 kg)

### Certifications

IP 55 rated. USCG ABS approved.

UL 1598A marine listed.

### Applications

- Narrow Housing
- Passageways
- Work Stations

Job Name \_\_\_\_\_

Fixture Type \_\_\_\_\_

Catalog No. \_\_\_\_\_

Approval \_\_\_\_\_

Date \_\_\_\_\_

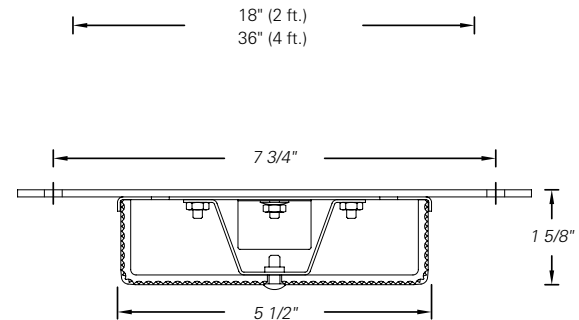
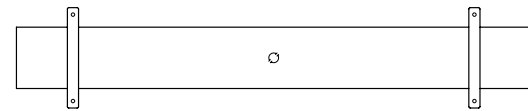
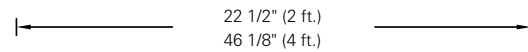
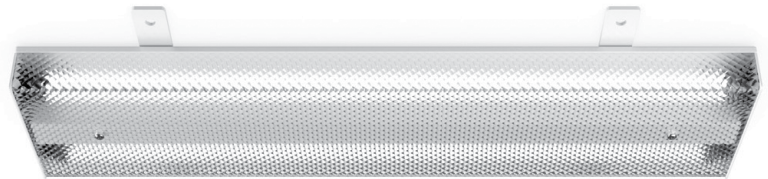

one LED Rows  
2 2 LED Rows

two Light Source  
L24/40 2-ft LED, 28W, 4000K  
L48/40 4-ft LED, 57W, 4000K

Modifications are available to meet custom requirements. Specifications and dimensions are subject to change without notice.