



M205-LED

Marine Surface Mount Low Profile **LED**

PRODUCT SPECIFICATION

Overhead Lighting

M205 Series

The M205 Series is designed for commercial marine and wet location surface mount ceiling applications. The design is drip-proof and easy to install and service.

Mounting

Surface-mounts to ceilings.

Light Source

LED.

Lens

One-piece 5/32 in. prismatic polycarbonate lens.

Housing

One-piece low profile aluminum housing with a liquid tight cord grip.

Finish

Polyester powder-coated after phosphate pretreatment for superior adhesion and corrosion resistance.

Weight

4 ft. luminaire: 6.8 lb. (3.1 kg)

2 ft. luminaire: 4.1 lb. (1.9 kg)

Certifications

IP 55 rated. USCG ABS approved.

UL 1598A marine listed.

Applications

- Narrow Housing
- Passageways
- Work Stations

Job Name _____

Fixture Type _____

Catalog No. _____

Approval _____ Date _____

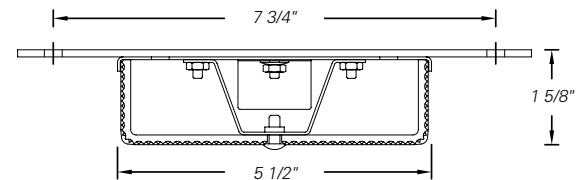
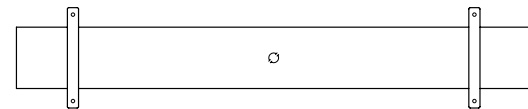
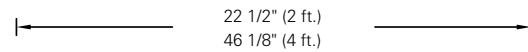
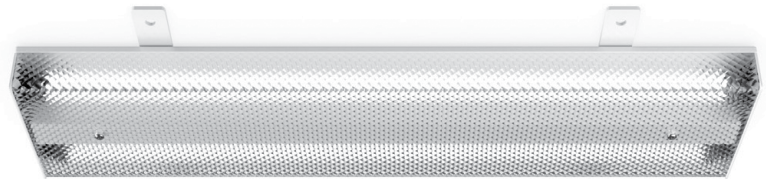

M205

one

two

one	LED Rows	two	Light Source
2	2 LED Rows	L24/40	2-ft LED, 28W, 4000K
4	2 LED Rows	L48/40	4-ft LED, 57W, 4000K

Modifications are available to meet custom requirements. Specifications and dimensions are subject to change without notice.