



VSB-LED Green

Vandal Resistant High Abuse Surface Mount **LED** Linear

PRODUCT SPECIFICATION

Designed for dust-free operation in surgical suites where symmetrical distribution illumination is required.

Mounting

Surface mounts to ceilings or walls. Able to be pendant mounted. Please contact factory.

Housing

Marine grade aluminum extruded housing and die-cast end caps.

Lens Frame

Marine grade aluminum extruded side rails and die-cast ends captivates lens.

Finish

Polyester powder-coated after phosphate pretreatment for superior adhesion and corrosion resistance.

Lens

.125 in. thick extruded polycarbonate snap-fits into lens frame. Fully illuminated opal lens completely hides diode image while maintaining excellent transmission.

Gasket

Closed cell foam gasket continuously seals lens frame to housing for up to IP67 rating.

Hardware

Stainless steel, tamperproof fasteners finished to match housing.

Driver

0-10Vdc 1% dimming, >0.9 PF, <20% THD
Factory programmable, Operating temp -40°C Min. to 50°C Max

Wiring

Driver provided with pre-wired 3-wire self-aligning input power quick disconnect and 2-wire quick disconnect to LED module.

Certifications

UL Listed wet location. IP65 rated. Optional IP66 (NEMA4 / 4X rated) and IP67 ratings available. Constructed to pass MIL-S-901 Grade A, Type A, High Impact Shock Test and MIL-S-167 Type 1, Vibration Test. Suitable for use in Natatorium Environments.

Job Name _____

Fixture Type _____

Catalog No. _____

Approval _____ Date _____



2 ft. and 4 ft. Fixtures

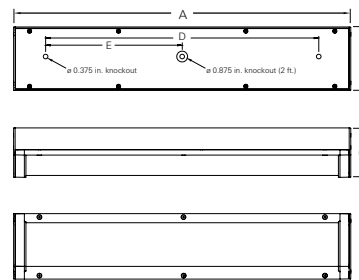

Corner Mounting Option

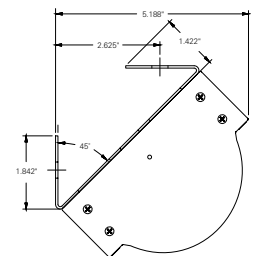

Size	A	B	C	D	E
2 ft.	24.2"	5.0"	3.7"	18"	9"
4 ft.	48.2"	5.0"	3.7"	42"	21"



VSB - one - two - three - four - five - six - seven - eight - nine - ten - eleven
 [VSB] - [XX] / [XX] - [VAR] [DM] - [OP]

one Luminaire Size

- 2 2 ft. fixture
- 4 4 ft. fixture

two LED Source

Refer to the LED Source Table on Page 2 for available options.

three Color Temperature

- 30 3000K
- 35 3500K
- 40 4000K
- 50 5000K

four CRI

- 80 80 CRI
- 90 90 CRI

five Voltage

VAR Variable, 120-277 V, 50/60Hz

six Driver

DM 0-10Vdc Dimming, standard

seven Lens

OP Opal polycarbonate, standard

eight Finish

- WH White
- BK Matte Black
- LG Light Gray
- CC Custom Color (Contact Factory)

nine Hardware

- TP Torx head, standard
- PH Phillips head

ten IP Rating

- 65 IP65 Rated, standard
- 66 IP66 Rated, NEMA4 / 4X Rated
- 67 IP67 Rated

eleven Options

- AM Anti-microbial coating (exposed areas)
- CM Corner mounting bracket
- CU Canadian UL Listing
- EM*¹ Emergency battery backup
- FH Fuse holder
- IMS*² Integral Occ Sensor
- PM Pendant mount
Pendant supplied by others. Customer must provide mounting hole template.
- PC Photocell
- RMxx*³ Row mounting
Includes Chase Nipple(s), PVC Gasket(s), and Sealing Locknut(s)
- NS NSF listing (refer to the NSF version of this cut sheet)

*EM = Not available on 1 ft. fixture
 *IMS = Not available on 1 ft. fixture
 *xx = Length of row in feet

Modifications are available to meet custom requirements. Specifications and dimensions are subject to change without notice.

CRI	LED Life
>80	>100,000

Green LED Only

LED Source (Box 2)	Size	Delivered Lumens	Watts
1G22	2 ft.	2270	22
1G45	4 ft.	4569	44

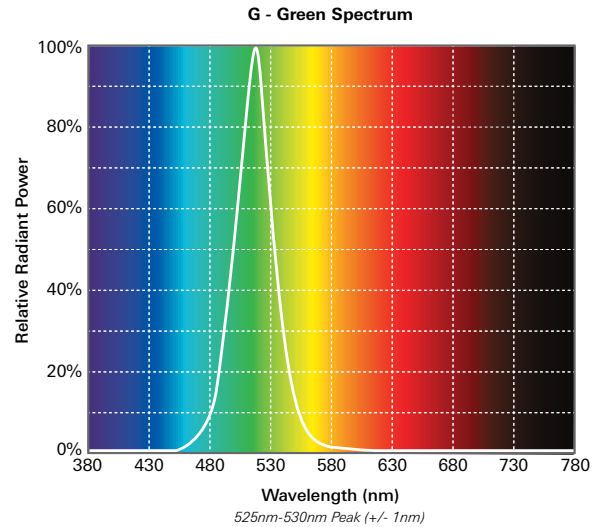

Specified Output Option

LC Doane programmable drivers allow us to deliver a specific lumen output. If none of the options in the chart above fit your application, let us know the desired lumen output and we will do the rest. See the example below on how this will be specified:

Example Model:

VSB2-**1W**SO40/80-VARDM-OPWH-TP65-(**XXXX**)

1W = We will determine the number of rows.

LUMENS = XXXX

Photometric Data @ 80 CRI

90 CRI multiplier	.83
-------------------	-----



Lifetime Warranty: We are proud to offer the L.C. Doane Assurance. L.C. Doane High Abuse lighting products are manufactured to withstand today's complex and demanding environments. The L.C. Doane Company will repair or replace any High Abuse or VR Architectural fixture when installed according to our instructions for the life of the original installation if the fixture should fail due to physical abuse.