



PRODUCT SPECIFICATION

The SG series is designed for use in all levels of security facilities and high abuse applications.

Mounting

Surface mounts to corner or wall.

Housing

Die-formed cold rolled steel with seams welded and ground smooth. Stainless steel available.

Door

One piece, die-formed cold rolled steel door with 14 gauge lens retainers and a full length welded pin piano hinge. Stainless steel available.

Finish

Polyester powder-coated after phosphate pretreatment for superior adhesion and corrosion resistance. Brushed stainless steel available.

Hardware

Recessed, stainless steel, tamper-proof fasteners.

Wiring

All electrical components are reflector-mounted for easy wiring and maintenance.

Certifications

UL Listed damp or wet location. Covered ceilings only.

Job Name _____

Fixture Type _____

Catalog No. _____

Approval _____ Date _____

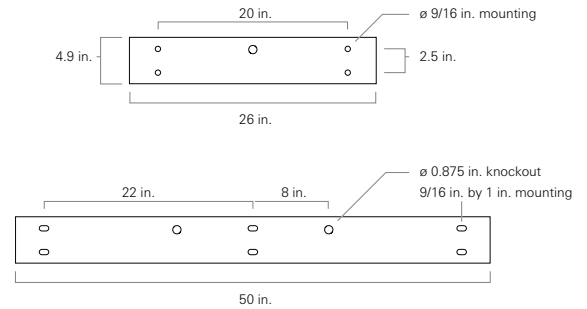
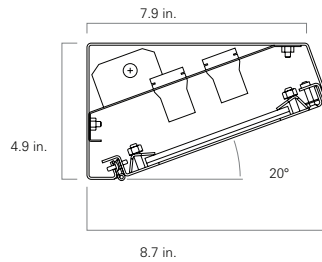

SG	one	two	three	four	five	six	seven	eight	nine	ten	eleven	twelve	thirteen	fourteen
----	-----	-----	-------	------	------	-----	-------	-------	------	-----	--------	--------	----------	----------

one	Lamps (not included)
14	2 ft. 14 W T5
17	2 ft. 17 W T8
24	2 ft. 24 W T5 HO
4B	2 ft. 40 W T5 biax
28	4 ft. 28 W T5
32	4 ft. 32 W T8
54	4 ft. 54 W T5 HO

two	Lamp Quantity
1	One
2	Two

three	Material Gauge
N	18 gauge, minimum security
D	16 gauge, medium security
X	14 gauge, maximum security

four	Material
C	Cold rolled steel
S	Stainless steel

five	Finish
R	Brushed stainless steel
W	White

six	Voltage
120	120 V, 60 Hz
277	277 V, 60 Hz
347	347 V, 60 Hz
VAR	Variable, 120-277 V, 50/60Hz
seven	Ballast
DM	Dimming
EL	Electronic Instant Start, <u>std T8</u>
PR	Program Rapid Start, <u>std T5, option T8</u>
eight	Internal Lens
53	.125 in. K12 prismatic acrylic
12	.125 in. K12 prismatic polycarbonate
15	.156 in. K12 prismatic polycarbonate
16	.187 in. K12 prismatic polycarbonate
75	.156 in. C73 prismatic tempered glass
01	.005 in. UV absorbing overlay
nine	External Lens
30	.187 in. clear polycarbonate
32	.250 in. clear polycarbonate
36	.375 in. clear polycarbonate
38	.500 in. clear polycarbonate
90	.187 in. clear tempered glass
92	.250 in. clear tempered glass
96	.375 in. clear tempered glass

ten	Door Fasteners
AP	Stainless steel allen head with pin
TP	Stainless steel torx head with pin
PH	Phillips head, non-security
eleven	Mounting Holes
D	Ceiling and wall mounting holes
W	Wall mounting holes only
twelve	Electrical Access
K	0.875 in. diameter knockout(s), <u>std</u>
thirteen	UL Listing
D	Damp Location
W	Wet Location
fourteen	Options
2C	Two-circuit wired
CU	Canadian UL Listing
E1	One lamp emergency ballast
E2	Two lamp emergency ballast
FH	Fuse and holder
NL	Night light, for 7 or 9 W PL bipin
NL-LED	Night light, LED
IMS	Integral Occ Sensor
PS	Security push on/off switch

Modifications are available to meet custom requirements.