



## Overhead Lighting M711 Series

The M711 Series unique universal mounting brackets are designed to allow either perpendicular or parallel recessed installation in modular ceilings. One fixture does both jobs.

### Mounting

Fits recessed within suspended ceilings.

### Housing

Cold rolled steel housing fits suspended ceiling systems using standard 11 13/16" (300 mm) linear ceiling panels with 1" (25mm) recess. Gap between housing and door on all sides provides clearance for ceiling panel lip, eliminating on-site ceiling panel notching.

### Door

Marine Grade Aluminum. Hinged door is retained with captive 1/4 turn closure screws and features side-off removal from housing. Doors are one ceiling panel wide, two or four panels long depending on fixture length.

### Lens

Optic Plus lens (standard) completely hides diode image while providing greater than 90% light transmission.

### Light source

Full-length LED array(s), with variable voltage, 0-10Vdc dimming driver (standard).

### Finish

White, powder coat polyester.

### Certifications

IP 44 rated. ABS approved.  
UL 1598A marine listed.

### Applications

- Dampa-style suspended ceilings
- Hallways
- Common Rooms

Job Name \_\_\_\_\_

Fixture Type \_\_\_\_\_

Catalog No. \_\_\_\_\_

Approval \_\_\_\_\_ Date \_\_\_\_\_

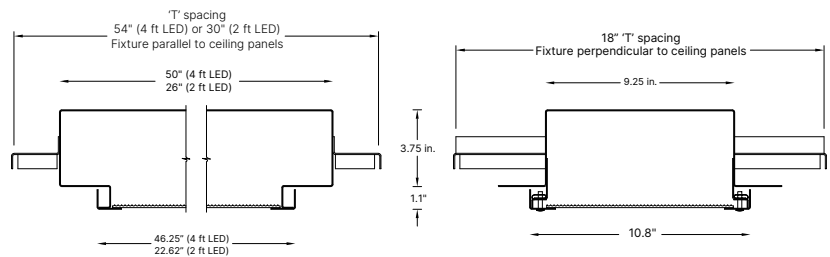

one two three four five six seven  
 M711 - - - VAR DM - 122 -

### one Luminaire

- 2 2 ft. fixture
- 4 4 ft. fixture

### two LED Designation

Refer to the LED Source Table on Page 2 for available options.

### three Color Temperature

- 30 3000K
- 35 3500K
- 40 4000K, standard
- 50 5000K

### four Voltage

VAR Variable 120-277V, 50/60Hz

### five Driver

DM 0-10Vdc dimming, standard

### six Lens

122 Optic Plus LED diffusing acrylic, standard

### seven Options

- EM Emergency ballast
- 2C Two-circuit wired
- U30 30mm U channel carrier mounting brackets
- C16 Dampa DCC 300 carrier 16 mounting brackets

Modifications are available to meet custom requirements. Specifications and dimensions are subject to change without notice.

CRI	LED Life
>80	>100,000

LED Source (Box 2)	3000K		3500K		4000K		5000K		Input Watts
	Delivered Lumens	L/W	Delivered Lumens	L/W	Delivered Lumens	L/W	Delivered Lumens	L/W	
<b>2' Fixture</b>									
1W19	1852	108	1880	110	1935	113	1991	116	17.1
1W25	2480	108	2517	109	2591	113	2665	116	23.0
1W31	3052	106	3098	108	3189	111	3280	114	28.7
2W41	3928	116	3987	118	4104	121	4221	125	33.8
2W47	4560	115	4628	117	4765	120	4901	124	39.6
<b>4' Fixture</b>									
1W19	1895	113	1923	115	1980	119	2036	122	16.7
1W36	3481	116	3533	118	3637	122	3740	125	29.9
1W47	4560	115	4628	117	4765	120	4901	124	39.6
2W56	5383	123	5463	125	5624	129	5785	133	43.6
2W68	6512	122	6609	124	6804	128	6998	131	53.3

## Specified Output Option

LC Doane programmable drivers allows us to deliver a specific lumen output. If none of the options in the chart above fit your application, let us know the desired lumen output and we will do the rest. See the example for a 4' on how this will be specified:

**Example Model:**

M711-2-**XX**<sup>1</sup>SO-40-VARDM-(**XX**<sup>2</sup>/LUMENS)

**LUMENS** = You provide the lumens.

**XX**<sup>1</sup> = We will determine the number of rows.

**XX**<sup>2</sup> = We will provide the wattage information.