



## PRODUCT SPECIFICATION

The SG series is designed for use in all levels of security facilities and high abuse applications.

### Mounting

Surface mounts to corner or wall.

### Housing

Die-formed cold rolled steel with seams welded and ground smooth. Stainless steel available.

### Door

One piece, die-formed cold rolled steel door with 14 gauge lens retainers and a full length welded pin piano hinge. Stainless steel available.

### Internal Lens

Optic Plus lens (standard) completely hides diode image while providing minimum 95% light transmission.

### Finish

Polyester powder-coated after phosphate pretreatment for superior adhesion and corrosion resistance. Brushed stainless steel available.

### Hardware

Recessed, stainless steel, tamper-proof fasteners.

### Driver

0-10Vdc dimming, Range 1%-100%  
-40°C Min. starting temperature, >0.9 PF, <20% THD.

### Wiring

Driver provided with pre-wired 3-wire self-aligning input power quick disconnect and 2-wire quick disconnect to LED module.

Job Name \_\_\_\_\_

Fixture Type \_\_\_\_\_

Catalog No. \_\_\_\_\_

Approval \_\_\_\_\_

Date \_\_\_\_\_

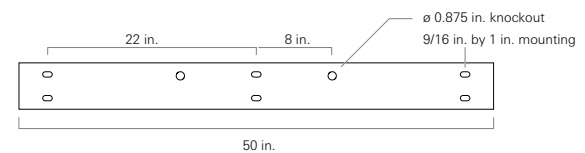
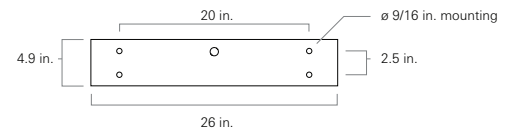
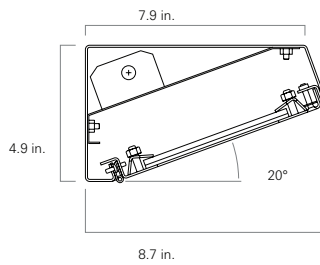

### Certifications

UL Listed damp or wet location. IP54 rated. Covered ceilings only.



**one Luminaire Size**  
2 2 ft fixture  
4 4 ft fixture

**two LED Rows**  
1L One  
2L Two

**three Color Temperature**  
30 3000K  
35 3500K  
40 4000K  
50 5000K

**four Material Gauge**  
N 18 gauge, minimum security  
D 16 gauge, medium security  
X 14 gauge, maximum security

**five Material**  
C Cold rolled steel  
S Stainless steel

**six Finish**  
R Brushed stainless steel  
W White

**seven Voltage**  
120 120 V, 60 Hz  
277 277 V, 60 Hz  
VAR Variable, 120-277 V, 50/60Hz

**eight Driver**  
DM 0-10Vdc Dimming, standard

**nine Internal Lens**  
122 Optic Plus LED diffusing acrylic lens, std  
53 .125 in. K12 prismatic acrylic  
12 .125 in K12 prismatic polycarbonate  
15 .156 in. K12 prismatic polycarbonate  
16 .187 in. K12 prismatic polycarbonate  
75 .156 in. C73 prismatic tempered glass

**ten External Lens**  
30 .187 in. clear polycarbonate  
32 .250 in. clear polycarbonate  
36 .375 in. clear polycarbonate  
38 .500 in. clear polycarbonate  
90 .187 in. clear tempered glass  
92 .250 in. clear tempered glass  
96 .375 in. clear tempered glass

**eleven Door Fasteners**  
AP Stainless steel allen head with pin  
TP Stainless steel torx head with pin  
PH Phillips head, non-security

**twelve Mounting Holes**  
D Ceiling and wall mounting holes  
W Wall mounting holes only

**thirteen Electrical Access**  
K 0.875 in. diameter knockout(s), std

**fourteen UL Listing**  
D Damp Location  
W Wet Location

**fifteen Options**  
SO Specified output\*  
2C Two-circuit wired  
CU Canadian UL Listing  
EM Emergency battery backup  
FH Fuse and holder  
NL-LED Night light, LED  
IMS Integral Occ Sensor  
PS Security push on/off switch

\* Indicated as SO(xx/xxxx). Specified output, Input watts / delivered lumens to be determined based on specified requirements

Modifications are available to meet custom requirements.